

3 Piece Design Metal Seated Ball Valve 150 Class

FlowBiz metal seated ball valve is used in critical applications and high temperature, high corrosion or abrasion, slurry and many more. Metal Seated Ball Valves are Engineered to outshine in the most demanding industrial perspectives, where valve insufficiencies can jeopardise safety, plant productivity and reduce profitability, FlowBiz metal seated ball valves stand out.

Size Range : 1/2 inch to 4 inch (15mm to 100mm)

End Connection : Screwed End / Flanged End

Standard

Design And Manufacturing	: BS EN ISO 17292
Valve Face To Face Dimension	: ASME B 16.10
Flange Standard Conformity	: ASME B 16.5 Class 150,
Inspection & Testing	: API 598 / FCI - 702 / BS EN 12266 - 1

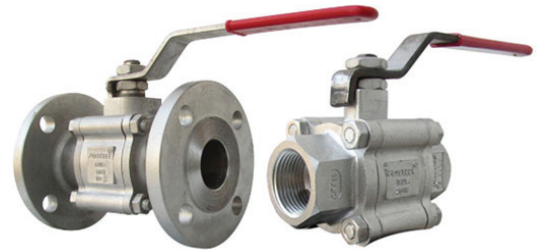

Key Features :

- Specialised coatings for harden-metal seats.
- Complies with shut off standards which include ANSI/FCI.
- Compatible with leakage Class V and VI.
- Bubble-tight shut-off.
- Exceptional result in corrosive fluids.
- Higher Threshold towards Abrasive particulates.
- Best for high temperatures up to 1000 Deg F (537 Deg C)
- Smooth operating towards hydraulic shock.

Specialised Coating Options :

- Stellite hard facing.
- Chromium carbide.
- Tungsten Carbide
- Electrolysis nickel plating.

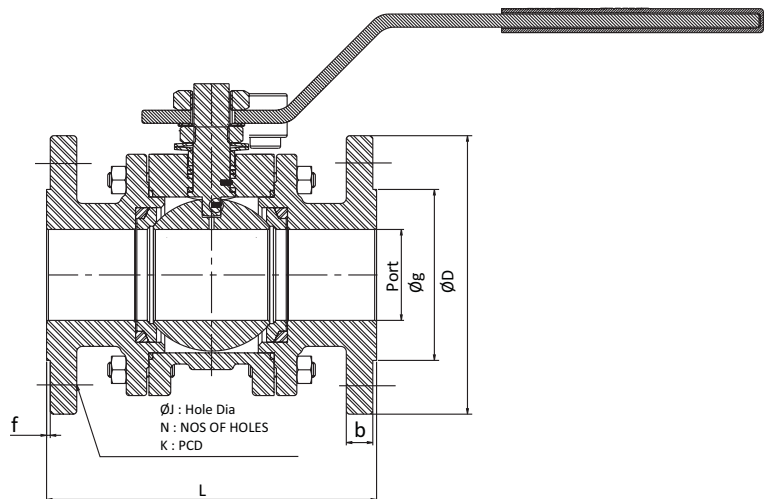

Dimensions : (All Dimensions are in mm)

Valve Model	Valve Size		Screwed		Flanged 150#									Weight (Approx) in Kgs
	MM	Inch	L	Weight Approx. in Kgs.	L	b	f	Port	Øg	ØD	ØJ	N	K : PCD	
BMS - 15	15	1/2"	71	1.550	108	8	2	13	34.9	90	15.9	4	60.3	1.600
BMS - 20	20	3/4"	94	1.880	117	8.9	2	19	42.9	100	15.9	4	69.9	2.400
BMS - 25	25	1"	108.5	2.720	127	9.6	2	25	50.8	110	15.9	4	79.4	3.500
BMS - 32	32	1 1/4"	116	3.950	140	11.2	2	32	63.5	115	15.9	4	88.9	5.000
BMS - 40	40	1 1/2"	128	5.200	165	12.7	2	38	73	125	15.9	4	98.4	7.000
BMS - 50	50	2"	158	9.100	178	14.3	2	49	92.1	150	19.05	4	120.7	11.200
BMS - 65	65	2 1/2"	185	13.100	190	15.9	2	62	104.8	180	19.05	4	139.7	17.500
BMS - 80	80	3"	205	15.100	203	17.5	2	74	127	190	19.05	4	152.4	20.00
BMS - 100	100	4"	216	25.000	229	22.3	2	100	157.2	230	19.05	8	190.5	33.00

Note : 300 & 600 Class Dimensions are on request.



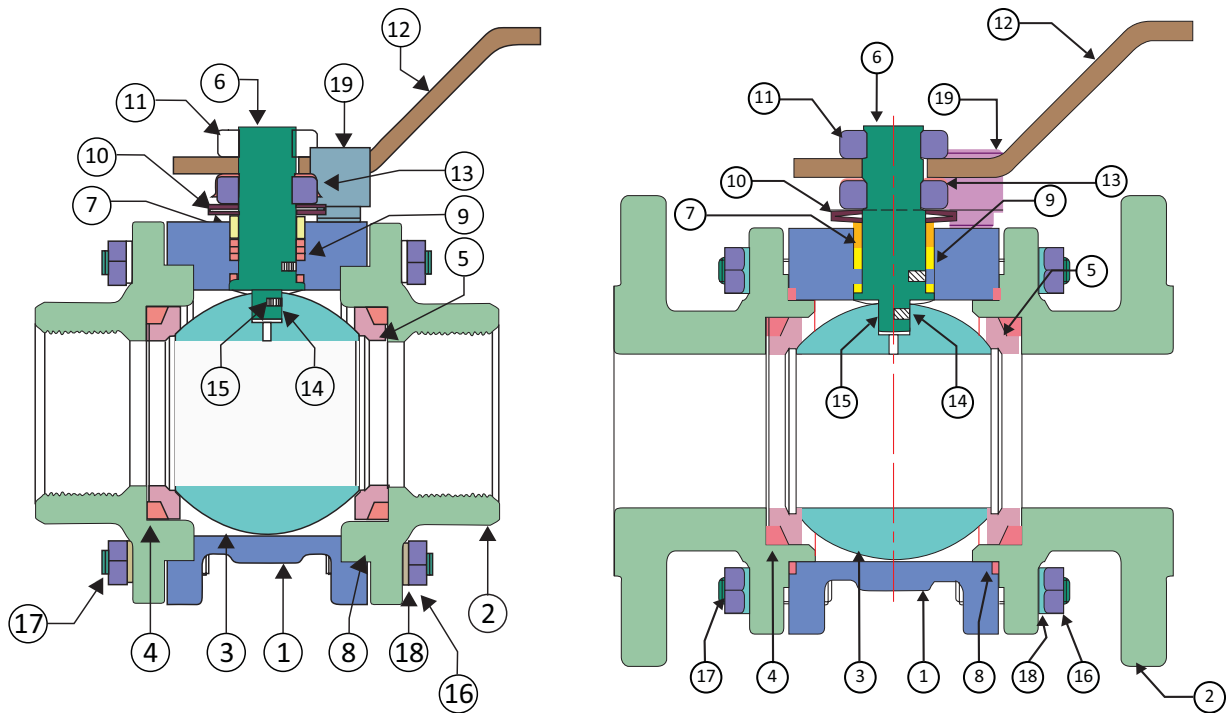

No.	Description	Material	Qty.
1	Body	WCB / CF8 / CF8M	01
2	End Connector	WCB / CF8 / CF8M	02
3	Ball	CF8 / CF8M	01
4	Ball Back	CFT	02
5	Ball Seat	AISI 304 / 316	02
6	Stem pin	AISI 304 / 316	01
7	Spacer Ring	AISI 304 / 316	01
8	Body Seat	CFT02	02
9	Stem Seat	CFT04	04
10	Disc Spring	Spring Steel	02
11	Stem Nut	S.S. 304	02
12	Handle	M.S. / S.S.	01
13	Lock Washer	S.S. 304	01
14	Antistatic Ball	S.S. 304	02
15	Antistatic Spring	S.S. 304	02
16	Fitting Nut	H.T. / S. S. 304	08
17	Fitting Stud	H.T. / S. S. 304	04
18	Spring Washer	H.T. / S. S. 304	08
19	Stopper Pin	M.S. / S.S. 304	01

